

Vertical Gun Case Assembly Instructions



For All ST Treker Vehicles

Manual No. 701-177M

Before You Start



When you see this symbol, the subsequent instructions and warnings are serious - follow without exception. Your life and the lives of others depend on it!

IMPORTANT: Before you begin, read these instructions and check to be sure all parts and tools are accounted for. Please retain these installation instructions for future reference and parts ordering information.

Your Vertical Gun Case is exclusively designed for your Land Pride Treker. Please read these installation instructions and your Treker Operator's Manual thoroughly before beginning. Especially read information relating to safety concerns. Also included in the Operator's Manual is important information on operation, adjustment, troubleshooting, and maintenance for this attachment (some manual sections do not apply to all accessories).

A separate Parts Manual for replacement parts can be purchased from your dealer or available free of charge at www.landpride.com. Have model and serial numbers handy when placing an order.

Manual Part Numbers:

- Operator's Manual (20 Series) 700-504M
- Parts Manual (20 Series) 700-504P
- Operator's Manual (00 & 10 Series) . . . 700-108M
- Parts Manual (00 Series) 700-108P
- Parts Manual (10 Series) 700-109P

General Information

These assembly instructions apply to the following Vertical Gun Case Kit listed below:

701-176A Vertical Gun Case Kit

Tools required:

- Safety Glasses
- Work Gloves
- Grease Pencil
- Framing Square
- Center Punch
- Hammer
- Drill with 5/16" Drill Bit
- Extension Cord (if required)
- Two 7/16" box end or open end wrenches

Further Assistance

Your dealer wants you to be satisfied with your new Vertical Gun Case. If for any reason you do not understand any part of this manual or are not satisfied with the service received, the following actions are suggested:

1. Discuss the matter with your dealership service manager making sure he is aware of any problems you may have and that he has had the opportunity to assist you.
2. If you are still not satisfied, seek out the owner or general manager of the dealership, explain the problem and request assistance.
3. For further assistance write to:

Land Pride Service Department
1525 East North Street
P.O. Box 5060
Salina, Ks. 67402-5060

E-mail address
lp servicedept@landpride.com

Assembly Instructions

A detailed listing of parts for the accessory kit is provided on page 4. Use the list as a checklist to inventory parts received. Please contact your local Land Pride dealer for any missing hardware.

Initial Preparations

Before servicing the vehicle the following procedure must be met to secure the vehicle:

1. Park vehicle on a level surface. **Don't work under or around a vehicle parked on an incline.**
2. Make the following gear and park brake selections:
 - a. 10 & 20 ST Series Trekers:
 - Set shift selector in Park.
 - b. 00 ST Series Trekers:
 - Set shift selector in forward gear.
 - Set park brake.
3. Turn ignition switch off and remove switch key.
4. Chock front and back of a wheel to prevent vehicle from rolling.

Assembly Instructions

Installation in Cab

Refer to Figure 1:

1. Measure 22" from passengers right side edge of the vehicle floor board. At that point, use a grease pencil to draw a 90 degree line on the floor board (#1) out from the fire wall. Make a mark at 6 1/4" and 9 3/4".
2. Measure straight up the fire wall from line drawn on the floor board 8 1/2" and make a third mark.
3. Hinge bench seat up to access back side of fire wall.
4. Be careful not to drill through electrical wiring or mechanical components located behind or under the panels. Drill 5/16" diameter holes on all three marks.

IMPORTANT: Protective caps (#10) must be installed onto the two 1/4" bolt ends located on the back side of the gun case to protect bench seat.

5. Install protective caps (#10) onto threaded ends of the two 1/4" bolts on the back side of the gun case.
6. Remove 1/4" nuts (#6) and lock washers (#8) from threaded studs on gun case bottom.
7. Insert threaded studs into the drilled holes in floor board. Do not secure studs with nuts at this time.

8. Install flat washer (#9) onto 1/4"-20 x 4" GR2 hex head cap screw (#5).
9. Insert cap screw with flat washer through the slot in vertical mounting bracket located on the back side of the gun case.
10. Install spacer (#3) onto cap screw (#5) and insert cap screw through 5/16" drilled hole in fire wall. Screw on 1/4" hex flange top lock nut (#7). **Do not tighten.**
11. Install flat washers (#9), lock washers (#8) and 1/4" nuts (#6) onto threaded studs at bottom of gun case. **Do not tighten.**
12. Ensure gun case is vertical and then tighten hex nuts (#6) and hex flange lock nut (#7) to 5.6 ft-lbs.

Installation of 2nd Gun Case

A second gun case can be installed on the floor board by using this same procedure above and locating it 6" to the left of the first gun case.

IMPORTANT: Care must be taken not to locate the gun case such that it would interfere with vehicle steering or foot controls.

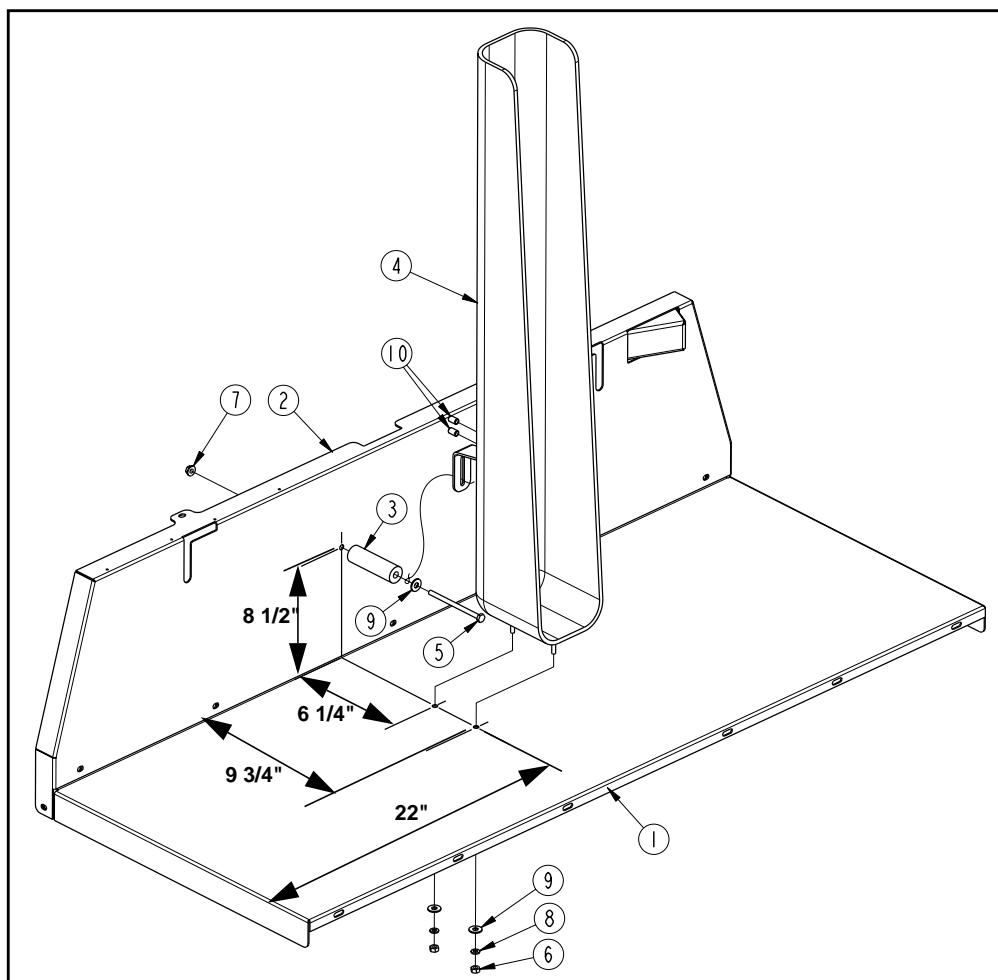

Figure 1

Assembly Instructions

Installation in Cargo Box

Refer to Figure 1:

1. Locate gun case a suitable distance from either the right or left side of cargo box side panel. At that point, use a grease pencil to draw a 90 degree line on the cargo box floor. Make a mark at $2\frac{7}{8}$ " and $6\frac{3}{8}$ ".
2. Measure straight up the front panel from line drawn on the floor $8\frac{1}{2}$ " and make a third mark. Hole height may vary due to corrugated floor and location of gun case.
3. Be careful not to drill through electrical wiring or mechanical components located behind or under the panels. Drill two $\frac{5}{16}$ " diameter holes in the floor. **Do not drill hole in front panel at this time.**
4. Remove $\frac{1}{4}$ " nuts (#2) and lock washers (#4) from threaded studs on gun case bottom.
5. Insert threaded studs into drilled holes in the floor. Do not secure studs with nuts at this time.
6. Place gun case rear slotted mounting bracket against front panel to verify mark in front panel is at the correct height. Once marked height is verified, drill a $\frac{5}{16}$ " diameter hole on that mark.
7. Insert $\frac{1}{4}$ "-20 x $\frac{3}{4}$ " hex head cap screw (#1) through front panel, slot in gun case rear mounting bracket and flat washer (#5). Screw on $\frac{1}{4}$ " hex flange top lock nut (#3). **Do not tighten lock nut.**
8. Install flat washers (#5), lock washers (#4) and $\frac{1}{4}$ " nuts (#2) onto threaded studs at bottom of gun case. **Do not tighten nuts.**
9. Ensure gun case is vertical and then tighten hex nuts (#2) and hex flange lock nut (#3) to 5.6 ft-lbs.
10. Install protective caps (#6) onto the threaded ends of the two $\frac{1}{4}$ " bolts on the back side of the gun case.

Installation of additional Gun Cases

Additional gun case can be installed in the cargo bed by repeating steps 1 through 10 above.

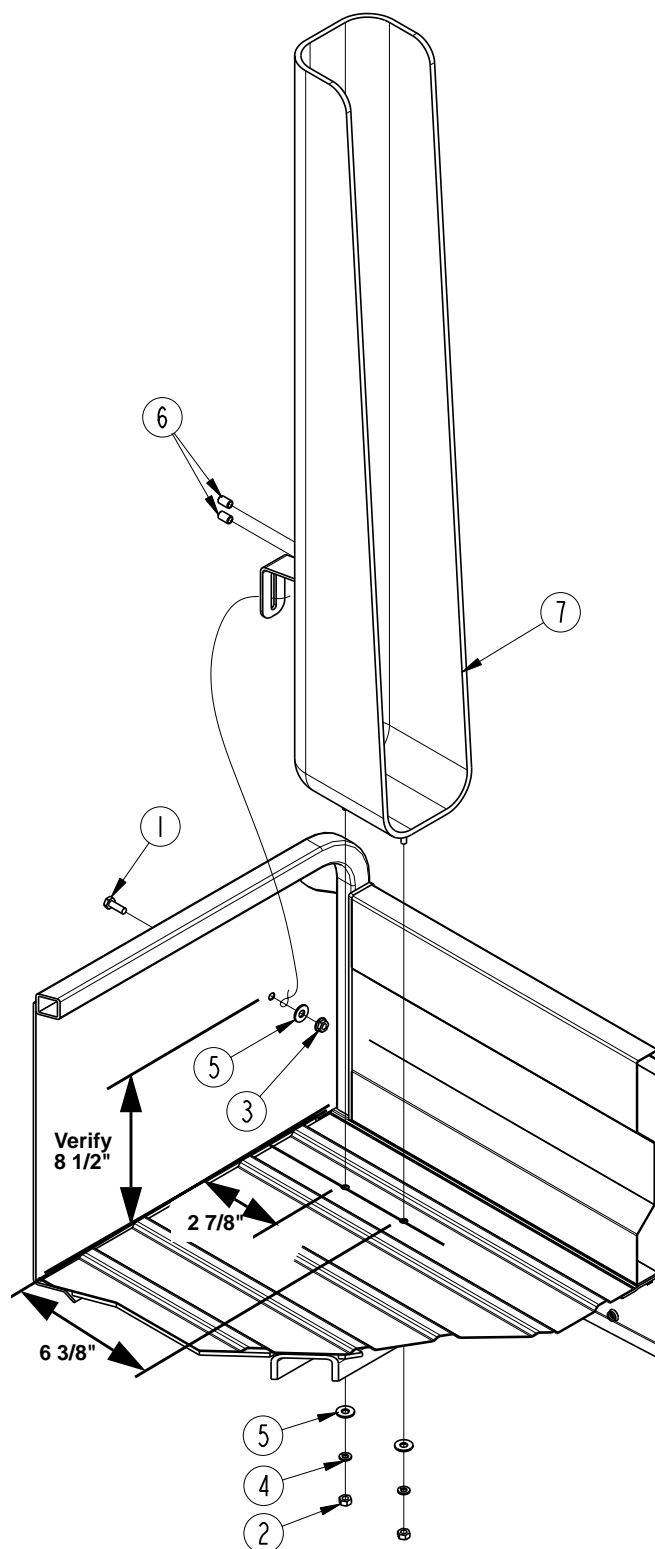

Figure 1

Kit No. 701-176A

Vertical Gun Case Kit

Qty.	Part No.	Part Description
1	701-177M	MANUAL, VERTICAL GUN CASE
1	840-325C	CASE, VERTICAL MOUNT GUN
1	701-187B	BAG, GUN CASE HARDWARE consisting of: 1 - SPACER, GUN CASE MOUNT 1 - HEX HEAD CAP SCREW 1/4-20 x 4" GR2 1 - HEX FLANGE CAP SCREW 1/4-20 x 3/4" GR5 1 - HEX FLANGE NUT, T-LOCK 1/4-20 3 - WASHER FLAT 1/4 USS PLT 2 - CAP, .24 ID X .5" LONG (BLACK)



Corporate Office: P.O. Box 5060
Salina, Kansas 67402-5060 USA
www.landpride.com
