

Seat Belt Installation Kit Assembly Instructions



Treker 4200/4400 ST & NT Series

Manual No. 701-109M

Before You Start



When you see this symbol, the subsequent instructions and warnings are serious - follow without exception. Your life and the lives of others depend on it!

These optional assembly instructions contain only information required to assemble the Seat Belt Installation Kit to the ST and NT Series Treker. A detailed Operator's Manual was supplied with the Treker. Refer to the Operator's Manual for additional specific information especially information relating to safety concerns. Also included in the Operator's Manual is important information on operation, adjustment, troubleshooting, and maintenance for this attachment (some manual sections do not apply to all options).

A separate Parts Manual for replacement parts can be purchased from your dealer or available free of charge at www.landpride.com. Have model and serial numbers handy when placing an order.

Manual Part Numbers:

- Treker Operator's Manual 700-108M
- Treker Parts Manual. 700-108P

General Information

These assembly instructions apply to the following Seat Belt Installation Kit options listed below:

701-100A Treker ST Series

701-101A Treker NT Series

ST Treker Assembly Instructions

A detailed listing of parts for kit no 701-100A is provided on page 5. Use the list that is for you Treker as a checklist to inventory parts received. See page 3 for NT Treker Assembly Instructions.

Initial Preparations



CAUTION!

Securely support cargo box in the up position to prevent injury when working under the cargo box.

1. Park vehicle on a flat surface, move gear shift lever to neutral, set park brake, and raise cargo box fully up. Securely support cargo box in the up position to prevent injury while working around the engine.
2. Turn off engine and remove ignition key.

ST Seat Belt Support Installation

Refer to Figure 1:

1. Insert 1/32" x 1 1/4" x 5 1/2" seat belt support bar (#1) into clip sleeve (#3) along side belt clip (#2) as shown.

Make certain seat belt support bar (#1) is positioned on the side opposite to the belt clip push button as shown.

2. Repeat step 1 for the second seat belt.

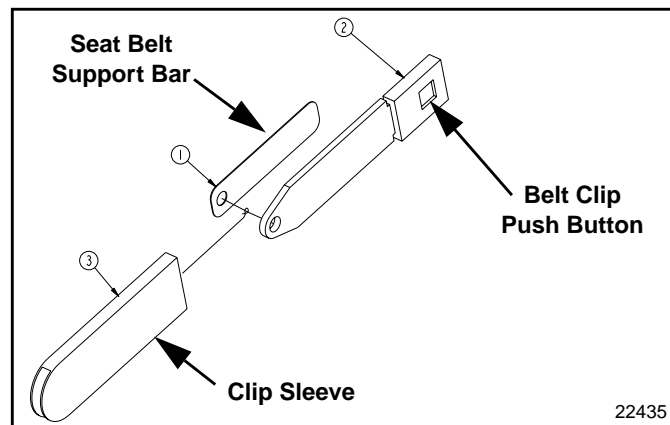

ST Seat Belt Support Installation
Figure 1

ST Seat Belt Installation to Mounting Bar

Refer to Figure 2:

1. Position the left seat belt clip (#2) with the push button facing towards the center of the vehicle.
2. One side of the clip sleeve (#2) has a hole and the other side does not. Raise the side of the clip sleeve that does not have a hole to expose the components under the sleeve and insert the 7/16" x 1 1/4" hex head bolt (#3) through the 7/16" flat washer (#5), hole in the seat belt support bar, hole in the seat belt and out through the hole on the other side of the clip sleeve.
3. Insert bolt (#3) with seat belt (#2) through the ear on the seat belt mount (#1) as shown. Secure with 7/16" stake hex nut (#4). Tighten nut to 78 ft. lbs. of torque.

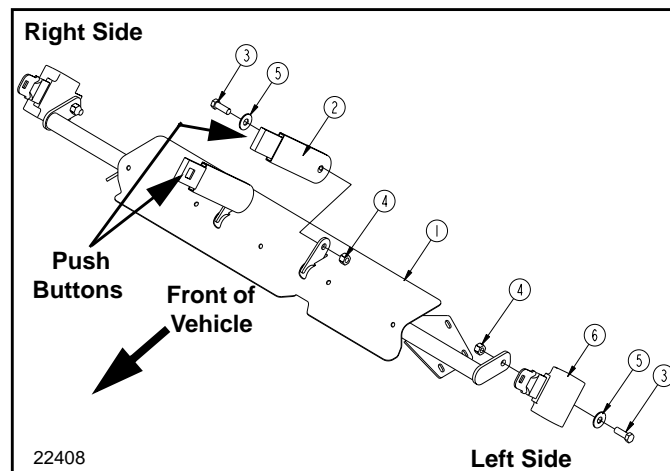

ST Seat Belt Installation To Mounting Bar
Figure 2

ST Treker Assembly Instructions

- Repeat steps 1 through 4 above for the right seat belt clip.
- Attach retractable seat belt (#6) to mounting bar (#1) by inserting 7/16" x 1 1/4" hex head bolt (#3) through 7/16" flat washer (#5), retractable seat belt (#6) and mounting lug on the left side of the seat belt mount (#1) as shown. Secure with 7/16" stake hex nut (#4). Tighten nut to 78 ft. lbs. of torque.
- Repeat step 6 to mount the second retractable seat belt to the mounting lug on the right side.

ST Mounting Bar Installation

Refer to Figure 3:

- Unscrew 5/16" nylock hex nuts (#4) (8-places).
- Remove and discard 5/16" x 3/4" hex bolts (#3).
- Insert mounting bar (#2) between accessory bar (#1) and vehicle frame as shown.
- Insert new 5/16" x 1" hex bolts (#3) (8-places). Do not secure with nuts until all bolts are inserted.
- Secure accessory bar and mounting bar with 5/16" nylock hex nuts (#4) (8-places). Tighten nuts to 17 ft. lbs. of torque.

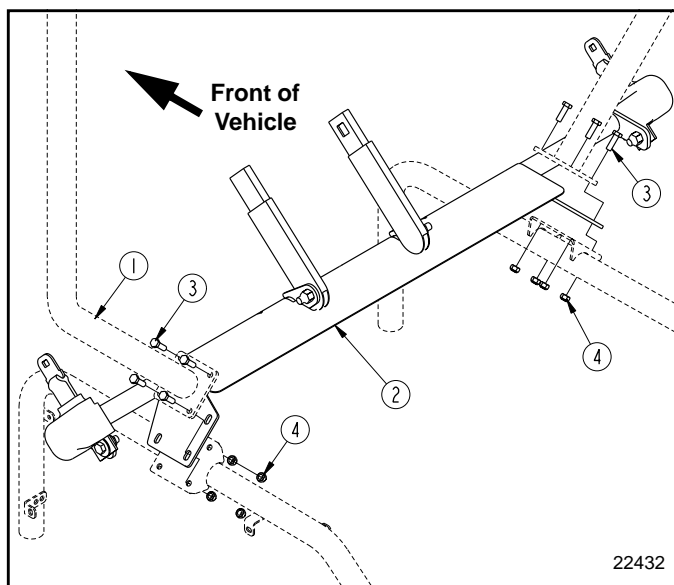

ST Mounting Bar Installation
Figure 3

ST Center Cover Plate Installation

Refer to Figure 4:

- Remove four 5/16" x 3/4" hex head cap screws (#3) used to secure existing center cover plate. Be careful not to lose the lock washers (#5) and flat washers (#4) while removing the cap screws.
- Remove existing cover plate and reinsert new cover plate (#2). Secure in place with existing 5/16" x 3/4" hex head cap screws (#3), lock washers (#5) and flat washers (#4). Tighten to 17 ft. lbs. of torque.

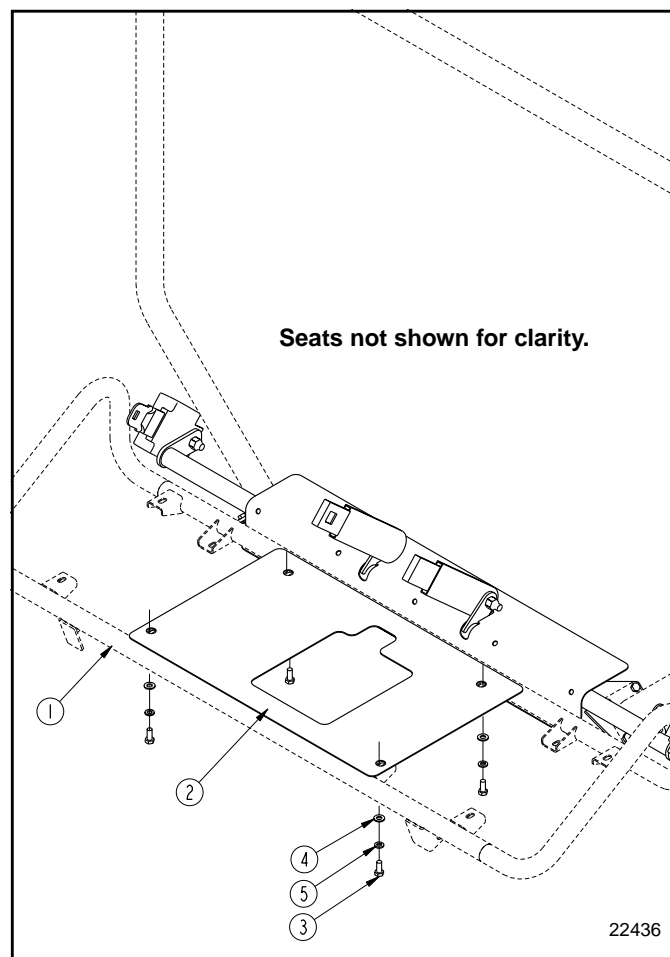

ST Center Cover Plate Installation
Figure 4

NT Treker Assembly Instructions

NT Treker Assembly Instructions

A detailed listing of parts for kit no 701-101A is provided on page 5. Use the list that is for your Treker as a checklist to inventory parts received.

Initial Preparations



CAUTION!

Securely support cargo box in the up position to prevent injury when working under the cargo box.

1. Park vehicle on a flat surface, move gear shift lever to neutral, set park brake, and raise cargo box fully up. Securely support cargo box in the up position to prevent injury while working around the engine.
2. Turn off engine and remove ignition key.

NT Seat Belt Support Installation

Refer to Figure 1:

1. Insert 1/32" x 1 1/4" x 5 1/2" seat belt support bar (#1) into clip sleeve (#3) along side belt clip (#2) as shown. Make certain seat belt support bar (#1) is positioned on the side opposite to the belt clip push button as shown.
2. Repeat step 1 for the second seat belt.

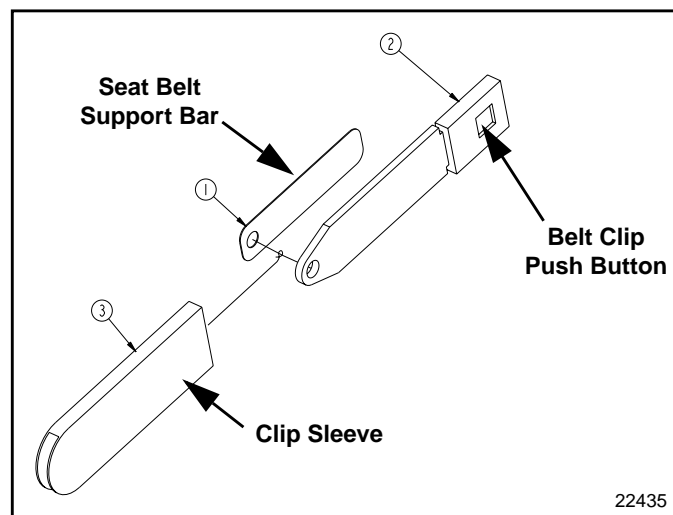

NT Seat Belt Support Installation
Figure 5

NT Seat Belt Installation to Mounting Bar

Refer to Figure 2:

1. Position the left seat belt clip (#2) with the push button facing towards the center of the vehicle.
2. Insert the seat belt clip assembly (#2) through the slot in the mounting bar (#1) as shown.
3. One side of the clip sleeve (#2) has a hole and the other side does not. Raise the side of the clip sleeve that does not have a hole to expose the components under the sleeve and insert the 7/16" x 1 1/4" hex head bolt (#3) through the 7/16" flat washer (#5), hole in the seat belt support bar, hole in the seat belt and out through the hole on the other side of the clip sleeve.
4. Insert bolt (#3) through the left ear on the seat belt mount (#1) as shown. Secure with 7/16" stake hex nut (#4). Tighten nut to 78 ft. lbs. of torque.
5. Repeat steps 1 to 4 above for the right seat belt clip.
6. Attach retractable seat belt (#6) to mounting bar (#1) by inserting 7/16" x 1 1/4" hex head bolt (#3) through 7/16" flat washer (#5), retractable seat belt (#6) and mounting lug on the left side of the seat belt mount (#1) as shown. Secure with 7/16" stake hex nut (#4). Tighten nut to 78 ft. lbs. of torque.
7. Repeat step 6 to mount the right side retractable seat belt to the mounting bar (#1).

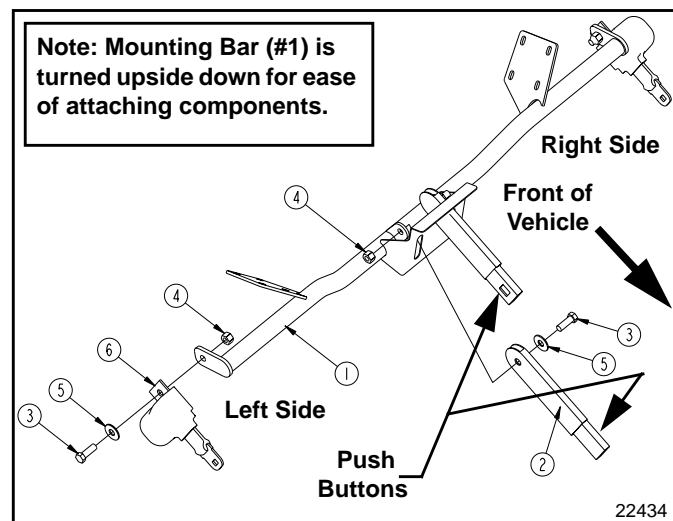

NT Seat Belt Installation To Mounting Bar
Figure 6

NT Treker Assembly Instructions

NT Mounting Bar Installation

Refer to Figure 3:

1. Unscrew 5/16" nylock hex nuts (#4) (8-places).
2. Remove and discard 5/16" x 3/4" hex bolts (#3).
3. Insert mounting bar (#2) between accessory bar (#1) and vehicle frame as shown.
4. Insert new 5/16" x 1" hex bolts (#3) (8-places). Do not secure with nuts until all bolts are inserted.
5. Secure accessory bar and mounting bar with 5/16" nylock hex nuts (#4) (8-places). Tighten nuts to 17 ft. lbs. of torque.

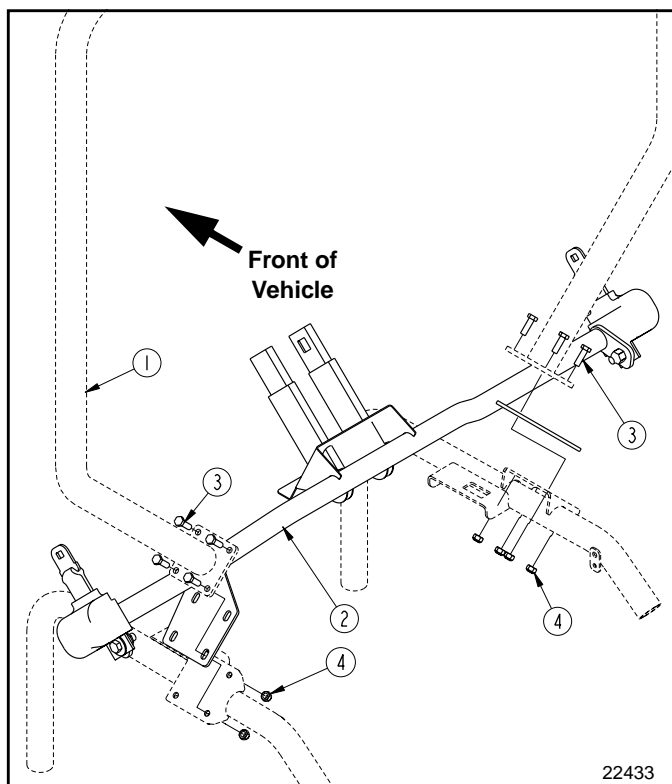

NT Mounting Bar Installation
Figure 7

NT Center Cover Plate Installation

Refer to Figure 4:

1. Remove six 5/16" x 3/4" hex head cap screws (#3). Four cap screws secure the right seat and the other two secure the left seat. Be careful not to lose lock washers (#5) and flat washers (#4) while removing the cap screws.
2. Remove right seat from Treker. (Seats not shown for clarity.)
3. Remove existing cover plate and reinsert new cover plate (#2).
4. Secure new cover plate and right seat with existing 5/16" x 3/4" hex head cap screws (#3), lock washers (#5) and flat washers (#4). Tighten to 17 ft. lbs. of torque.

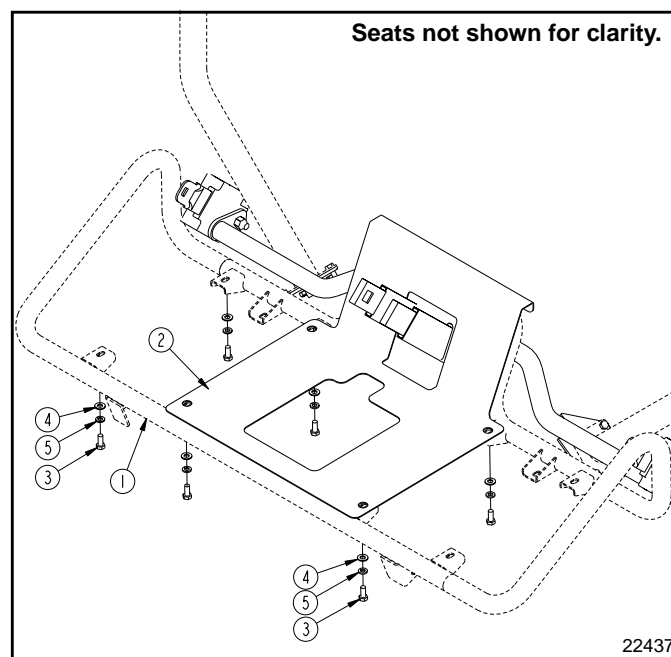

NT Center Cover Plate Installation
Figure 4

Listing of Parts**Kit No. 701-100A****ACCESSORY SEAT BELT KIT (ST)**

Qty.	Part No.	Part Description
1	701-109M	MANUAL, TREKER SEAT BELT INSTRUCTIONS
1	700-235H	SEAT BELT MOUNT (ST)
1	700-325D	SEAT CENTER COVER PLATE
2	720-244D	SEAT BELT SUPPORT
8	802-738C	HHCS 5/16-18X1 GR5
2	840-180C	SEATBELT RETRACTABLE

Kit No. 701-101A**ACCESSORY SEAT BELT KIT (NT)**

Qty.	Part No.	Part Description
1	701-109M	MANUAL, TREKER SEAT BELT INSTRUCTIONS
1	700-240H	SEAT BELT MOUNT (NT)
1	700-337D	SEAT CENTER PLATE-BELTS
2	720-244D	SEAT BELT SUPPORT
8	802-738C	HHCS 5/16-18X1 GR5
1	838-486C	DECAL WARNING GNRAL UTLTY VHCL
2	840-180C	SEATBELT RETRACTABLE



Corporate Office: P.O. Box 5060
Salina, Kansas 67402-5060 USA
www.landpride.com
