

# Spring Seat Kit Assembly Instructions



For ZXT, ZT & ZTi Zero Turn Mowers

Manual No. 357-404M

## Before You Start



When you see this symbol, the subsequent instructions and warnings are serious - follow without exception. Your life and the lives of others depend on it!

**IMPORTANT:** Before you begin, read these instructions and check to be sure all parts and tools are accounted for. Please retain these installation instructions for future reference and parts ordering information.

Your Spring Seat Kit is exclusively designed for Land Pride's ZXT54, ZXT60, ZT60, ZT72, ZT60i & ZT72i model mowers. Please read these installation instructions and your Zero Turn Operator's Manual thoroughly before beginning. Especially read information relating to safety concerns.

A separate Parts Manual for replacement parts can be purchased from your nearest Land Pride dealer or downloaded free of charge from our web site at [www.landpride.com](http://www.landpride.com). Have model and serial numbers handy when placing an order.

### Manual Part Numbers:

#### Operator's Manual

- ZXT54 & ZXT60 ..... 357-271M
- ZT60 & ZT72 ..... 357-103M
- ZT60i & ZT72i ..... 357-398M

#### Parts Manual

- ZXT54 & ZXT60 ..... 357-271P
- ZT60 & ZT72 ..... 357-103P
- ZT60i & ZT72i ..... 357-398P

## General Information

These assembly instructions apply to the following Spring Seat Kit listed below:

- 357-395A SPRING SEAT KIT**
- 357-405A AUXILIARY SPRING KIT (Sold Separately)**

## Tools required:

- Safety glasses
- Work gloves
- 3/8" or 1/2" ratchet wrench with set of sockets
- 9/16" box end or open end wrench
- 3/4" box end or open end wrench
- 1/4" Hex Socket Wrench
- Spray bottle with soapy water

## Further Assistance

If for any reason you do not understand any part of this manual or are not satisfied with the service received, the following actions are suggested:

1. Discuss the matter with your dealership service manager making sure he is aware of any problems you may have and that he has had the opportunity to assist you.
2. If you are still not satisfied, seek out the owner or general manager of the dealership, explain the problem and request assistance.
3. For further assistance write to:

**Land Pride Service Department**  
**1525 East North Street**  
P.O. Box 5060  
Salina, Ks. 67402-5060

E-mail address  
[lp servicedept@landpride.com](mailto:lp servicedept@landpride.com)

## Assembly Instructions

A detailed listing of parts for each accessory kit is provided on page 3. Use the list that is for your Spring Seat Kit as a checklist to inventory parts received. Please contact your local Land Pride dealer for any missing hardware.

## Initial Preparations

1. Park unit on a flat level surface. Make sure blade engagement switch is **(OFF)**, both control levers are fully **(OUT)**, park brake is **(ON)** and switch key is turned **(OFF)** and removed.

## Assembly Instructions

### Seat Disassembly

#### Refer to Figure-1:

Deluxe Seat (#17) will need to be removed from seat support platform (#2) before the Spring Seat Kit can be installed.

1. Rotate seat support platform (#16) up to expose underside of seat and platform.
2. (Not shown) Unplug wire harness from seat switch.
3. Remove lock nuts (#17), flat washers (#18), spacers (#15) and deluxe seat (#19).
4. Store seat and hardware in a safe place for reattachment.

### Spring Seat Kit Assembly Kit No. 357-395A

#### Refer to Figure-1:

1. Install seat pan springs (#10) to spring saddle (#3) with 1/2"-13 x 1" GR5 cap screws (#5), 1/2" SAE flat washers (#9) and hex flange nuts (#7) as shown. Tighten hex flange nuts to 76 ft-lbs.
2. Attach spring saddle (#3) to seat support platform (#16) as shown with two 3/8"-16 x 3/4" GR5 cap screws (#4) and flanged lock nuts (#8). Tighten lock nuts to 31 ft-lbs.
3. Attach pivot plate adapter (#1) to seat support platform (#16) as shown with 3/8"-16 x 3/4" GR5 cap screws (#4) and hex flanged lock nuts (#8). Tighten lock nuts to 31 ft-lbs.
4. Insert 1" rubber bumper (#11) into hole in back of hinge spring pan (#2). Make sure bumper is fully inserted.
5. Attach Auxiliary spring kit decal (#14) to spring pan hinge (#2) in the location shown.
6. Reattach deluxe seat (#19) to hinge spring pan (#2) as shown with existing spacers (#15), existing 5/16" SAE flat washers (#18) and existing 5/16"-18 lock nuts (#17). Tighten nuts to 11 ft-lbs.
7. Insert flange bearing (#12) in holes at the front of hinge spring pan (#2). Make certain the bearing flanges are located on the outside of the hinge.

**IMPORTANT:** Make sure rubber bumper (#11) is inserted through and below rectangle opening in seat support platform (#16) before attaching hinge spring pan (#2) to pivot plate adapter (#1).

8. Insert hinge spring pan tab and rubber bumper (#11) through rectangle opening in seat support platform (#16).
9. Attach hinge spring pan (#2) to pivot plate (#1) with 3/8"-16 shoulder bolt (#6) and hex flange lock nuts (#8). Tighten nuts to 20 ft-lbs.
10. Reattach existing wiring harness to seat switch with wire extension kit supplied, safety seat switch harness (#13). (Item #13 not shown.)

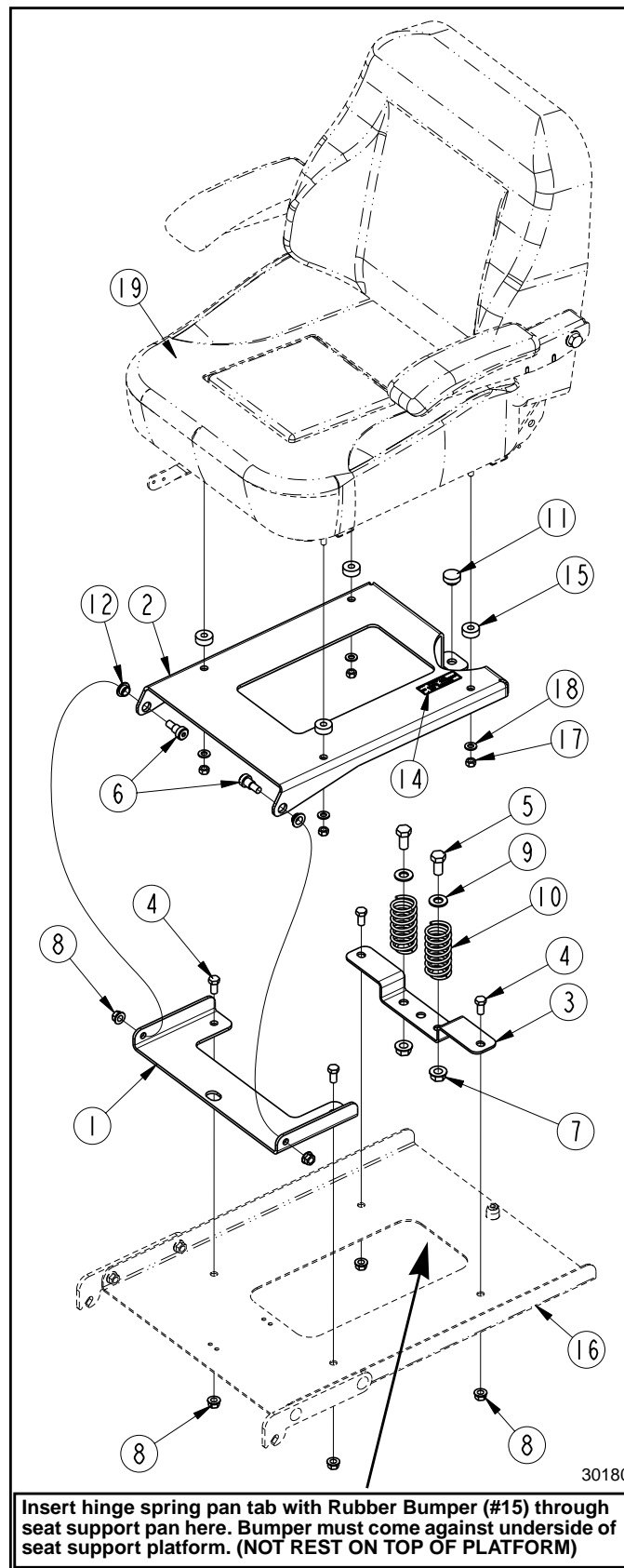

Spring Seat Kit Assembly  
Figure-1

## Assembly Instructions

### Auxiliary Spring Kit (Sold Separately) Kit No. 357-405A

Refer to Figure-2:

A third spring (#3) can be added to the deluxe seat. The hinge spring pan (#6) will need to be removed to access spring saddle (#5).

1. Remove 3/8" hex flange lock nuts (#10) and 1/2" shoulder bolts (#8).
2. Remove hinge spring pan (#6) and seat assembly from pivot plate adapter (#7). Be careful not to lose flange bearings (#9) from the hinge spring pan.
3. Install auxiliary seat pan spring (#3) to spring saddle (#5) with 1/2"-13 x 1" GR5 cap screw (#1), 1/2" SAE flat washer (#2) and hex flange nut (#4) as shown.
4. Tighten hex flange nut to 76 ft-lbs.
5. Insert hinge spring pan tab with rubber bumper (#11) through rectangle opening in the seat support platform.
6. Attach hinge spring pan (#6) to pivot plate (#7) with 3/8"-16 shoulder bolt (#8) and hex flange lock nuts (#10). Tighten nuts to 20 ft-lbs.

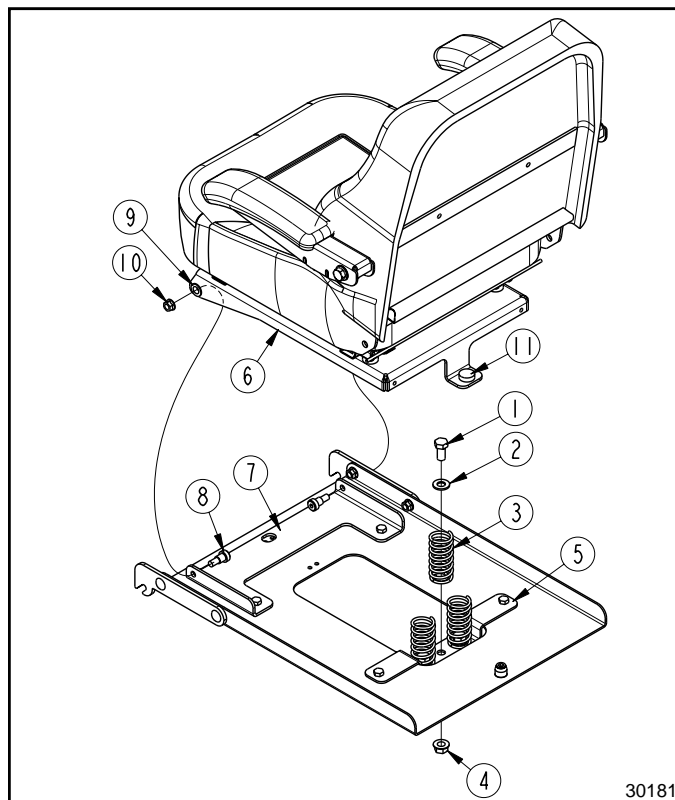

Auxiliary Spring Kit  
Figure-2

### Kit No. 357-395A                      SPRING SEAT KIT

Item	Part No.	Part Description	Qty
	357-404M	MANUAL, SPRING SEAT PAN	1
1	357-910D	PIVOT PLATE ADAPTER	1
2	357-911D	HINGE SPRING PAN	1
3	357-912D	SPRING SADDLE	1
4	802-014C	HHCS 3/8-16X3/4 GR5	4
5	802-258C	HHCS 1/2-13X1 GR5	2
6	802-747C	SHLDR BLT 1/2DX1/2L 3/8-16 SS	2
7	803-193C	NUT HEX FLANGE 1/2-13 GR G PLT	2
8	803-209C	NUT FLANGE LOCK 3/8-16 PLT	6
9	804-016C	WASHER FLAT 1/2 SAE PLT	2
10	807-288C	SPRG 1.55ODX1.65WX3.5L SEATPAN	2
11	816-483C	BUMPER, 1.00X.31THK PUSH IN	1
12	817-560C	BSHG FLG .50IDX.62ODX.31L	2
13	833-445C	HARNESS ASSY,SEAT SWITCH	1
14	848-496C	DECAL, AUX SPRING KIT	1

### Kit No. 357-405A                      AUXILIARY SPRING KIT (Sold Separately)

Item	Part No.	Part Description	Qty
1	802-258C	HHCS 1/2-13X1 GR5	1
2	804-016C	WASHER FLAT 1/2 SAE PLT	1
3	807-288C	SPRG 1.55ODX1.65WX3.5L SEATPAN	1
4	803-193C	NUT HEX FLANGE 1/2-13 GR G PLT	1



Corporate Office: P.O. Box 5060  
Salina, Kansas 67402-5060 USA  
[www.landpride.com](http://www.landpride.com)

---