

**Rotary Tillers**

<b>RTA25 &amp; RTA35 Series</b>			
	<b>RTA2562-06</b>	<b>RTA2570-06</b>	<b>RTA3576</b>
<b>Recommended Tractor PTO HP</b>	25-55 Horsepower (55 hp maximum)		35-75 Horsepower (75 hp maximum)
<b>Weight</b>	649 lbs.	663 lbs.	856 lbs.
<b>Tilling Width</b>	62"	70"	76"
<b>Overall Width</b>	67 5/8"	75 5/8"	81 5/8"
<b>3-Point Hitch Type</b>	Category I, Adjustable Lower Hitch Clevis with Plated Pins		Category 1 & 2, Adjustable Lower Hitch Clevis
<b>Quick Hitch Compatible</b>	<b>Cat. I</b>	Yes	Yes
	<b>Cat. II</b>	No	No
<b>Offset Capabilities</b>	Yes (Cannot offset with Quick-Hitch)		
<b>Number of Flanges</b>	8	9	8
<b>Number of Tines per Flange</b>	6		
<b>Tine Construction</b>	High Carbon heat treated "C" shaped blades		
<b>Skid Shoes</b>	Adjustable		
<b>Storage Stands</b>	Adjustable		
<b>Rear Deflector</b>	Spring Loaded, adjustable, profile stamped rear deflector		
<b>Driveline</b>	ASAE Category III Heavy Duty Slip-Clutch		ASAE Category IV Heavy Duty Slip-Clutch
<b>Gearbox</b>	45 HP at 540 rpm 1.92:1 Ratio		65 HP at 540 rpm 1.87:1 Ratio
<b>Gearbox Construction</b>	Cast Iron Housing, Straight Bevel Gears		
<b>Gearbox Lubrication</b>	SAE 80-90W EP oil		
<b>Gearbox Oil Capacity</b>	2 Pints	3.17 Pints	6.3 Pints
<b>Drive Chain</b>	#100 Roller chain Fully enclosed in oil bath with drain plug, fill plug and skid protection		
<b>Chain Case Oil Type</b>	Shell Alvania EP 00 or equivalent		
<b>Sprockets</b>	Splined Bores		
<b>Rotor Swing Diameter</b>	17"		19"
<b>Rotor Shaft Speed</b>	220 rpm at 540 rpm PTO		204 rpm at 540 rpm PTO

*Designs, specifications, features and information are subject to change without notice.*

Rotary Tillers

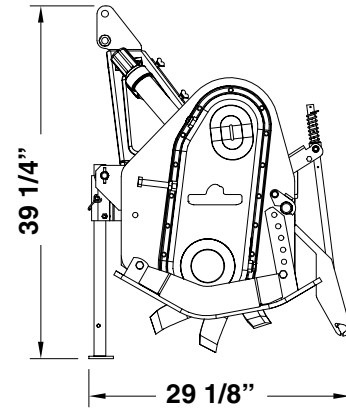
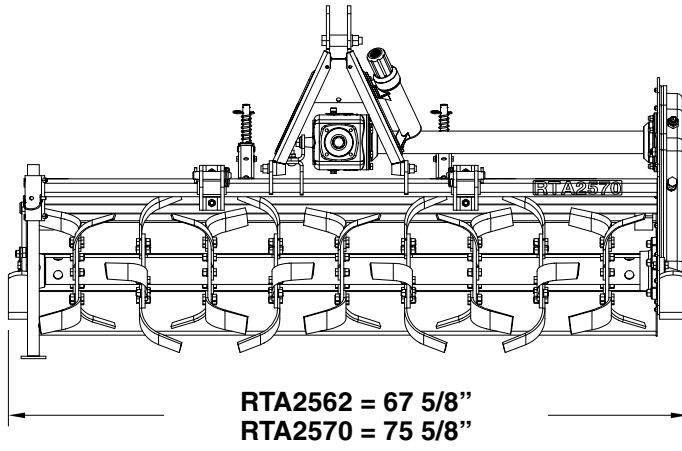

RTA25 Series

26801

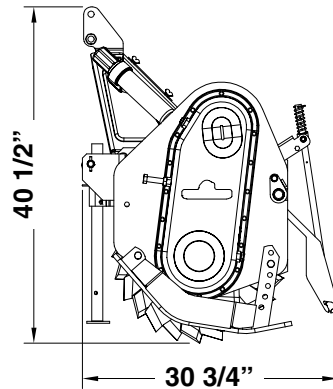
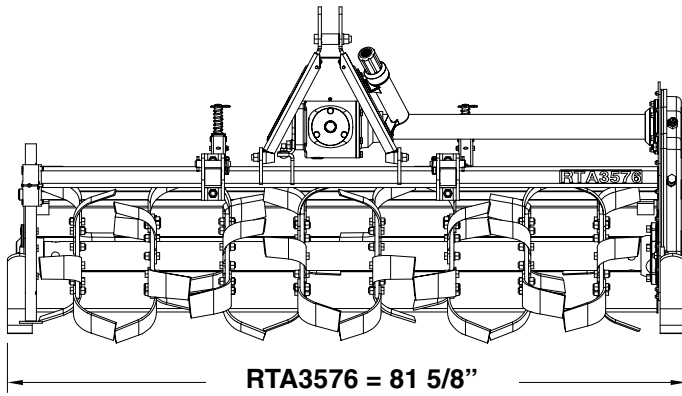

RTA35 Series

26803

Designs, specifications, features and information are subject to change without notice.