

CVT Alignment Tool Instructions



4200/4400 NT/ST, 4210/4410 ST & 4220/4420ST Series Manual No. 790-007M

Before You Start



When you see this symbol, the subsequent instructions and warnings are serious - follow without exception. Your life and the lives of others depend on it!

IMPORTANT: Before you begin, read these instructions and check to be sure all parts and tools are accounted for. Please retain these installation instructions for future reference and parts ordering information.

Your CVT Alignment Tool is exclusively designed to correctly align engine and trans-axle on your Land Pride Treker models 4200NT, 4400NT, 4200ST, 4400ST, 4210ST, 4410ST, 4220ST and 4420ST. Please read these operating instructions and your Treker Operator's Manual thoroughly before beginning. Especially read information relating to safety concerns.

Separate Manuals can be purchased from your dealer or available free of charge at www.landpride.com. Have model and serial numbers handy when placing an order.

Manual Part Numbers:

- Operator's Manual (20 Series) 700-504M
- Parts Manual (20 Series) 700-504P
- Operator's Manual (00 & 10 Series) . . . 700-108M
- Parts Manual (00 Series) 700-108P
- Parts Manual (10 Series) 700-109P

Refer to Figure 1:

This instruction Manual apply to kit number:

790-006A TREKER ENGINE/TRANS ALIGN TOOL

This kit consists of one alignment tool (#1), one alignment spacer (#2), and this manual (#3). Please contact your local Land Pride dealer for missing components.

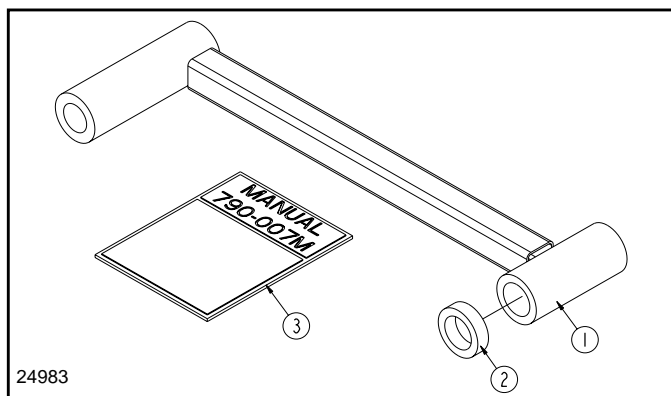

790-006A CVT Alignment Tool Kit
Figure 1

Instructions

The alignment tool is designed to work with all models of Land Pride Trekers. However, when using this tool, it is important to know which clutch ("A", "B" or "C") is on your Treker. Please take time to identify which drive clutch is being mounted to your Treker engine.

Clutch "A" is furnished with 4220ST & 4420ST Trekers.

Some 4210ST & 4410ST Trekers have been updated to clutch "A".

Also a few 4200NT, 4200ST, 4400NT & 4400ST Trekers have been updated to clutch "A".

Use .404" thick spacer included with alignment tool for alignment. Remove spacer before CVT installation.



Clutch "A"

Clutch "B" is furnished with 4210ST & 4410ST Trekers.

Some 4200NT, 4200ST, 4400NT & 4400ST Trekers have been updated to clutch "B".

Use .466" thick spacer included with clutch for alignment and CVT installation.



Clutch "B"

Clutch "C" is furnished with 4200NT, 4200ST, 4400NT & 4400ST Trekers only.

Use .466" thick spacer included with clutch for alignment and CVT installation.



Clutch "C"

Refer to Figure 1 and Clutches "A", "B" & "C"

- If clutch "A" is used, then alignment spacer (#2) must be used with alignment tool (#1).
- If clutch "B" or "C" is used, then alignment spacer (#2) is not used. Spacer supplied with clutch is used with alignment tool (#1).

Instructions

Refer to Figure 2:

For all three clutches the distance from center of engine shaft to center of trans-axle shaft is 14.375" +0/-0.063"

The offset distance from spacer on engine shaft to boss on trans-axle shaft is 2.341" +/- .031"

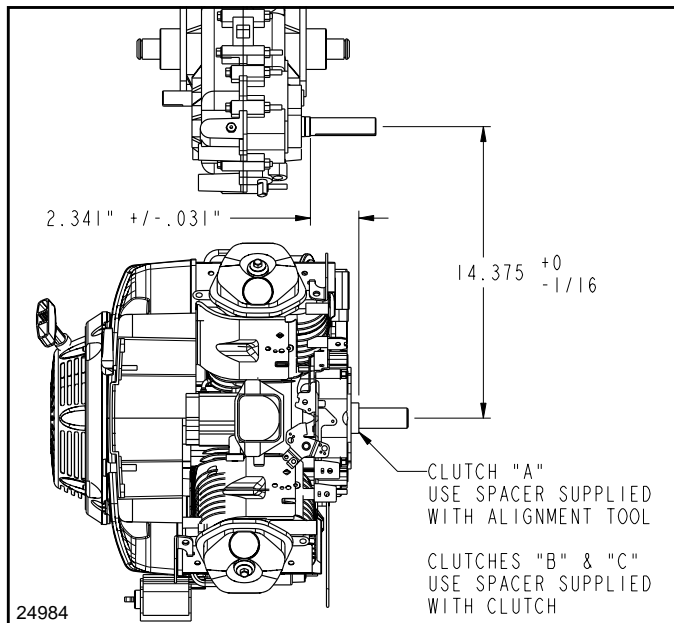

790-006A CVT Alignment Tool Kit
Figure 2

Instructions for Clutch "A"

Refer to Figure 3:

1. Remove CVT system and loosen trans-axle mounting hardware.
2. Install on engine output shaft .404" thick spacer (#2) supplied with alignment tool.

NOTE: Install alignment tool (#1) with long portion of tube towards the trans-axle.

3. Install alignment tool (#1) on engine output shaft and trans-axle input shaft.

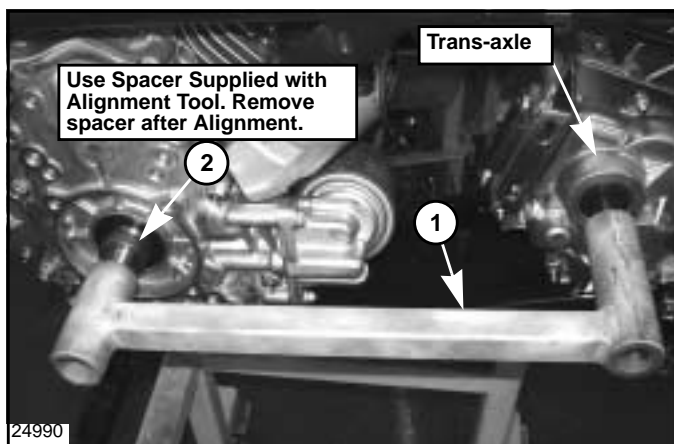

Placement of Alignment Tool for Clutch "A"
Figure 3

4. With alignment tool holding the two shafts apart at 14.375" spacing, tighten trans-axle mounting hardware to proper torque.
5. Alignment spacer should be against engine boss and alignment tool should be in contact with trans-axle boss and alignment spacer. If not, then add shims (700-112A) as necessary to remove the gap.
6. Remove alignment tool (#1) and spacer (#2).
7. Install CVT system.

Instructions for Clutches "B" & "C"

Refer to Figure 4:

1. Remove CVT system and loosen trans-axle mounting hardware.
2. Install on engine output shaft .466" thick spacer (#2) supplied with clutch.

NOTE: Install alignment tool (#1) with long portion of tube towards the trans-axle.

3. Install alignment tool (#1) onto engine output shaft and trans-axle input shaft.

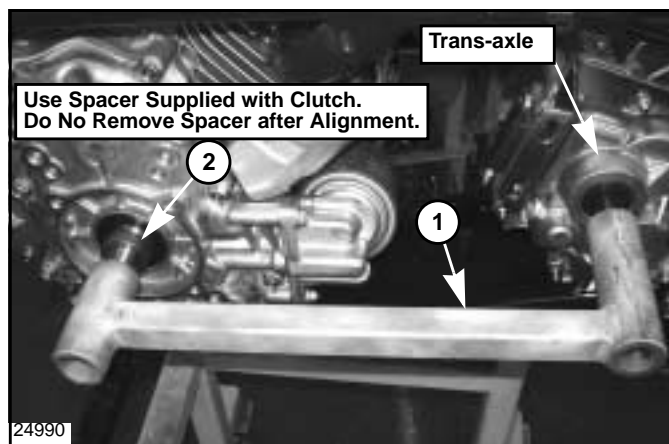

Placement of Alignment Tool for Clutches "B" & "C"
Figure 4

4. With alignment tool holding the two shafts apart at 14.375" spacing, tighten trans-axle mounting hardware to proper torque.
5. Alignment tool should be in contact with boss on trans-axle shaft and spacer (#2) on engine shaft. Add shims (700-112A) as needed to fill in the gap.
6. Remove alignment tool (#1). Leave spacer (#2) on the engine shaft and install CVT system.



Corporate Office: P.O. Box 5060
Salina, Kansas 67402-5060 USA
www.landpride.com